

Step 1 MOUNT

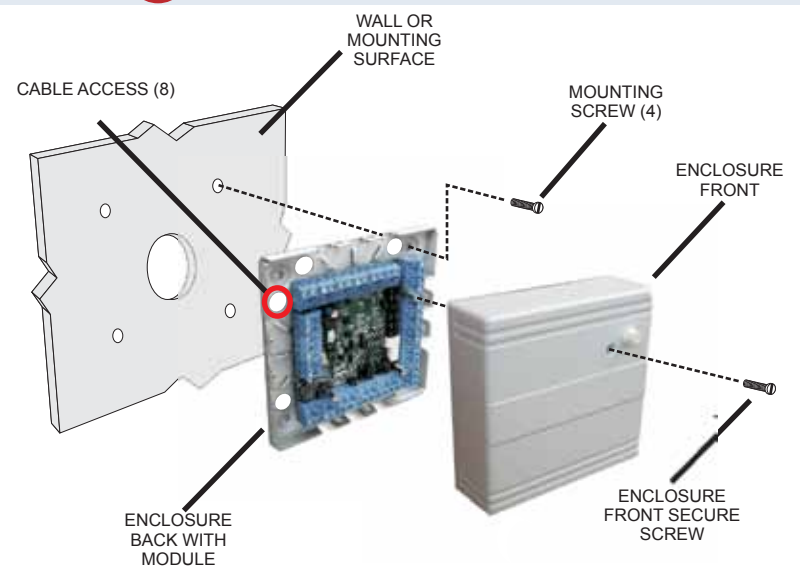

Step 2 WIRE

- A** Connect Master Unit 524 and Door Unit RS485 between Master Unit and Door Unit modules
Set each Door Unit address for the RS485 channel 12 to 24V DC Power Source (24V recommended)
- B** Connect FPK (TLR401B) RS485 reader to Door Unit
12V DC (red)
GND (black)
RS485A (Pink)
RS485B (Gray)
- C** Connect door locking hardware
Locking device (magnetic lock shown)
Door contact (Integrated in magnetic lock)
Request for exit / PIR (exit button shown)
Locking hardware power (DC Power Source)

Step 3 NETWORK

- A** Ethernet connection
Using CAT5 patch cable connect the Master Unit 524 to an Ethernet router or directly to a PC using a CAT5 crossed cable
- B** Setting the IP address
Set the IP address of the connected PC to allow connection to the Master Unit 524 default IP address 192.168.50.140

(see Software Configuration Manual for details)

For illustration only; local municipality code may require alternate configuration

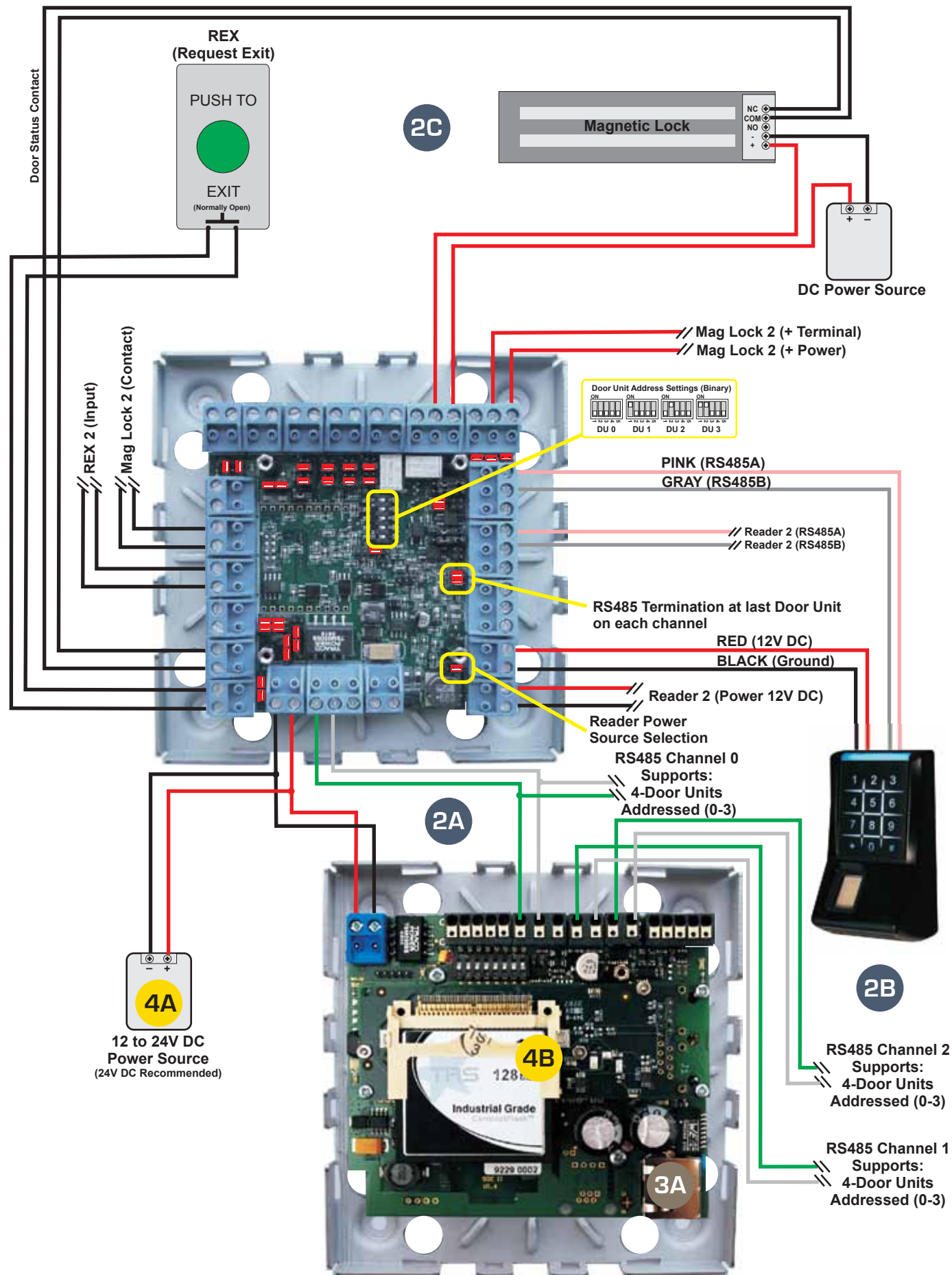

Step 4 POWER ON

- A** Plug in DC power source
- B** Verify the Master Unit 524 LED indicators
 - L1 (On = Future Use)
 - L2&3 (Flashing = Application Running)
 - L4 (On = 3.3 V DC Power On)
 - L5 (On = 5 V DC Power On)
 - L6 (On = USB Power)
 - L7 (On = CPU Power)

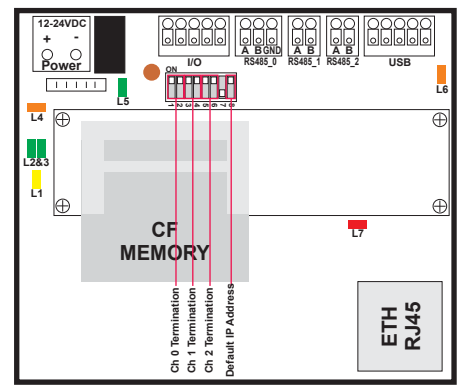

Step 5 LOG IN AND CONFIGURE

- A** Connecting to the Master Unit 524
Open the Web browser of the connected PC
Enter the default IP address of 192.168.50.140 at the address line
The "User Login and Status" screen is displayed



- B** Log in to the system
Enter the name "user1"
Enter the password "pw"
Click Logon
- C** Modify the system for your unique application
Modify the pre-loaded configuration to your needs
Enroll Cards and add Persons as required

(see Software Configuration Manual for details)

Step 1 MOUNT

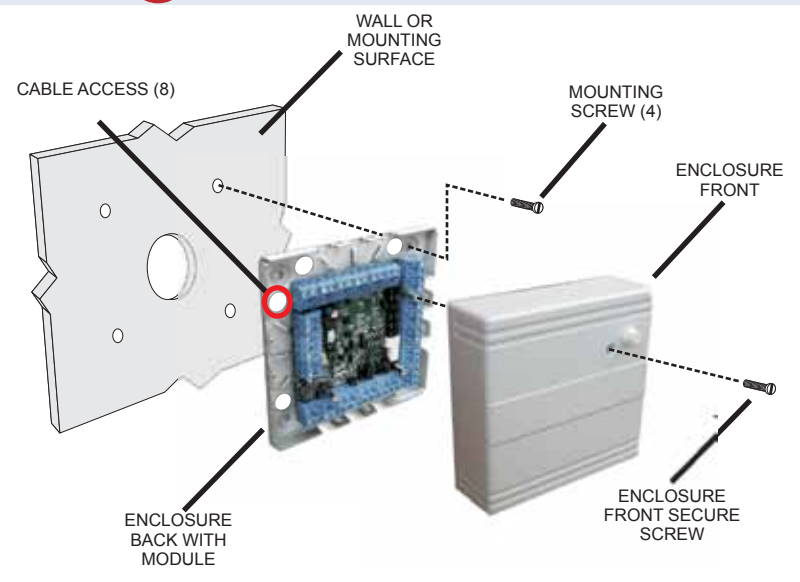

Step 2 WIRE

- A** Connect Master Unit 524 and Door Unit RS485 between Master Unit and Door Unit modules
Set each Door Unit address for the RS485 channel 12 to 24V DC Power Source (24V recommended)
- B** Connect FPK (TLR401B) RS485 reader to Door Unit
12V DC (red)
GND (black)
RS485A (pink)
RS485B (gray)
- C** Connect door locking hardware
Locking device (electric strike shown)
Door contact (monitors door status)
Request for exit / PIR (exit button shown)
Locking hardware power (DC Power Source)

Step 3 NETWORK

- A** Ethernet connection
Using CAT5 patch cable connect the Master Unit 524 to an Ethernet router or directly to a PC using a CAT5 crossed cable
- B** Setting the IP address
Set the IP address of the connected PC to allow connection to the Master Unit 524 default IP address 192.168.50.140

(see Software Configuration Manual for details)

For illustration only; local municipality code may require alternate configuration

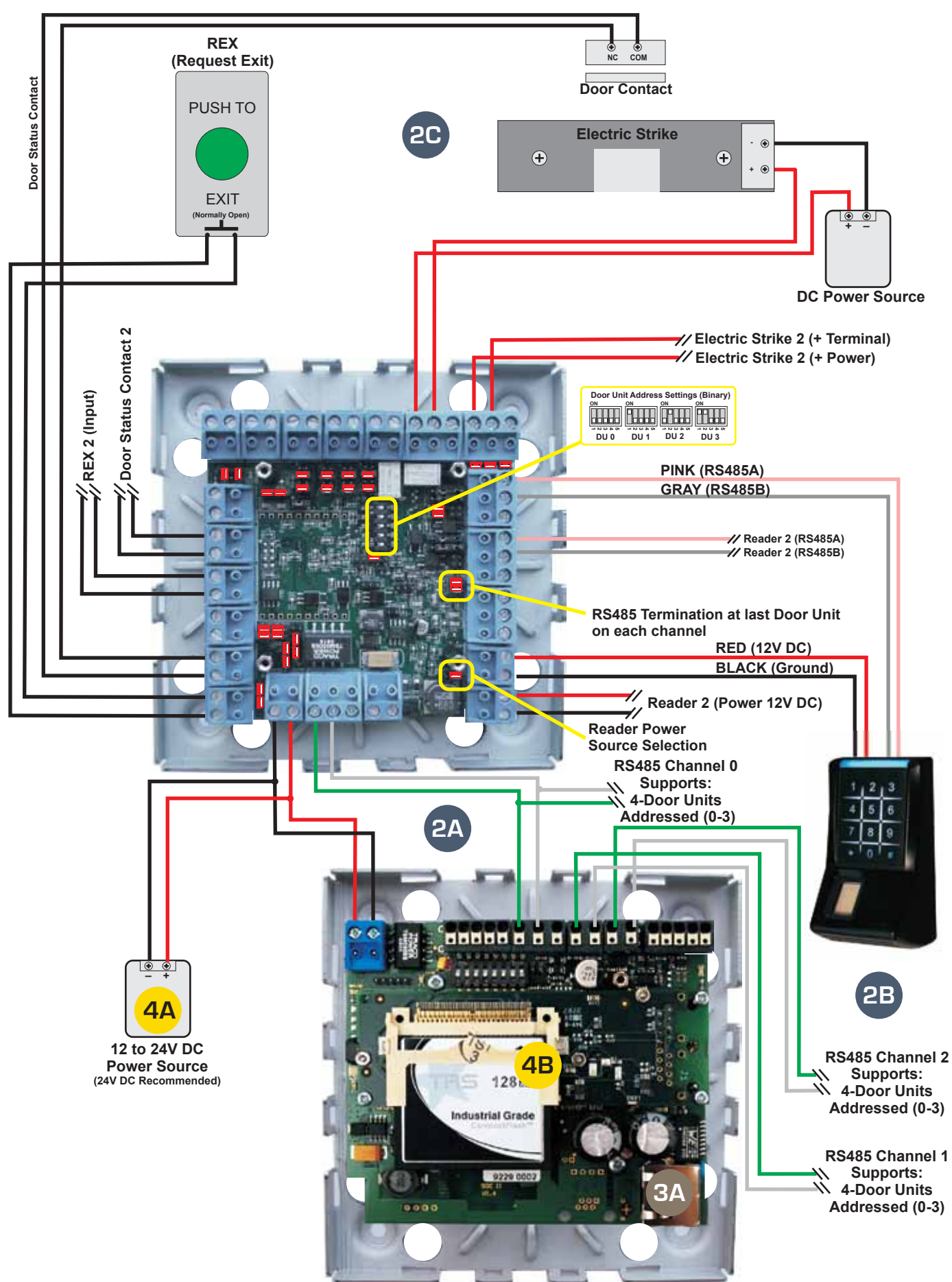

Step 4 POWER ON

- A** Plug in DC power source
- B** Verify the Master Unit 524 LED indicators
 - L1 (On = Future Use)
 - L2&3 (Flashing = Application Running)
 - L4 (On = 3.3 V DC Power On)
 - L5 (On = 5 V DC Power On)
 - L6 (On = USB Power)
 - L7 (On = CPU Power)

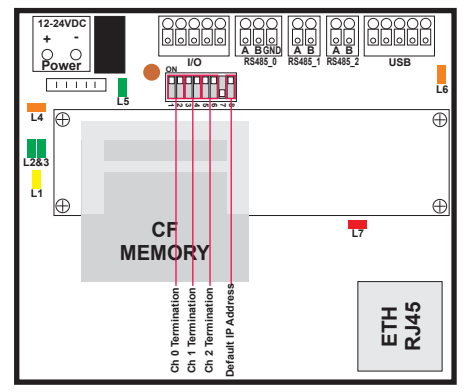

Step 5 LOG IN AND CONFIGURE

- A** Connecting to the Master Unit 524
Open the Web browser of the connected PC
Enter the default IP address of 192.168.50.140 at the address line
The "User Login and Status" screen is displayed



- B** Log in to the system
Enter the name "user1"
Enter the password "pw"
Click Logon
- C** Modify the system for your unique application
Modify the pre-loaded configuration to your needs
Enroll Cards and add Persons as required

(see Software Configuration Manual for details)

Step 1 MOUNT

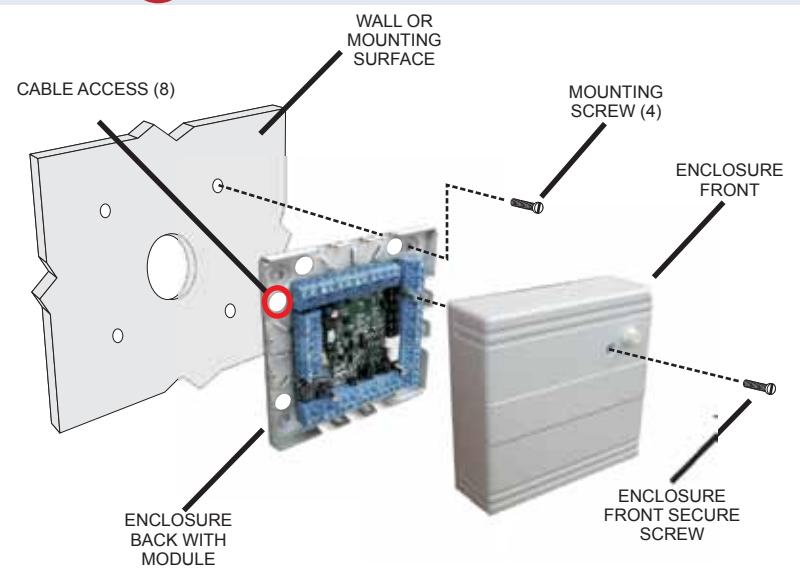

Step 2 WIRE

- A** Connect Master Unit 524 and Door Unit RS485 between Master Unit and Door Unit modules
12 to 24V DC Power Source (24V recommended)
- B** Connect FPK (TLR401B) reader to Door Unit
12V DC (red)
GND (black)
Data 0 (green)
Data 1 (white)
Shield (violet)
Beeper (yellow)
Green LED (orange)
- C** Connect door locking hardware
Locking device (magnetic lock shown)
Door contact (Integrated in magnetic lock)
Request for exit / PIR (exit button shown)
Locking hardware power (DC Power Source)

Step 3 NETWORK

- A** Ethernet connection
Using CAT5 patch cable connect the Master Unit 524 to an Ethernet router or directly to a PC using a CAT5 crossed cable
 - B** Setting the IP address
Set the IP address of the connected PC to allow connection to the Master Unit 524 default IP address 192.168.50.140
- (see Software Configuration Manual for details)

For illustration only; local municipality code may require alternate configuration

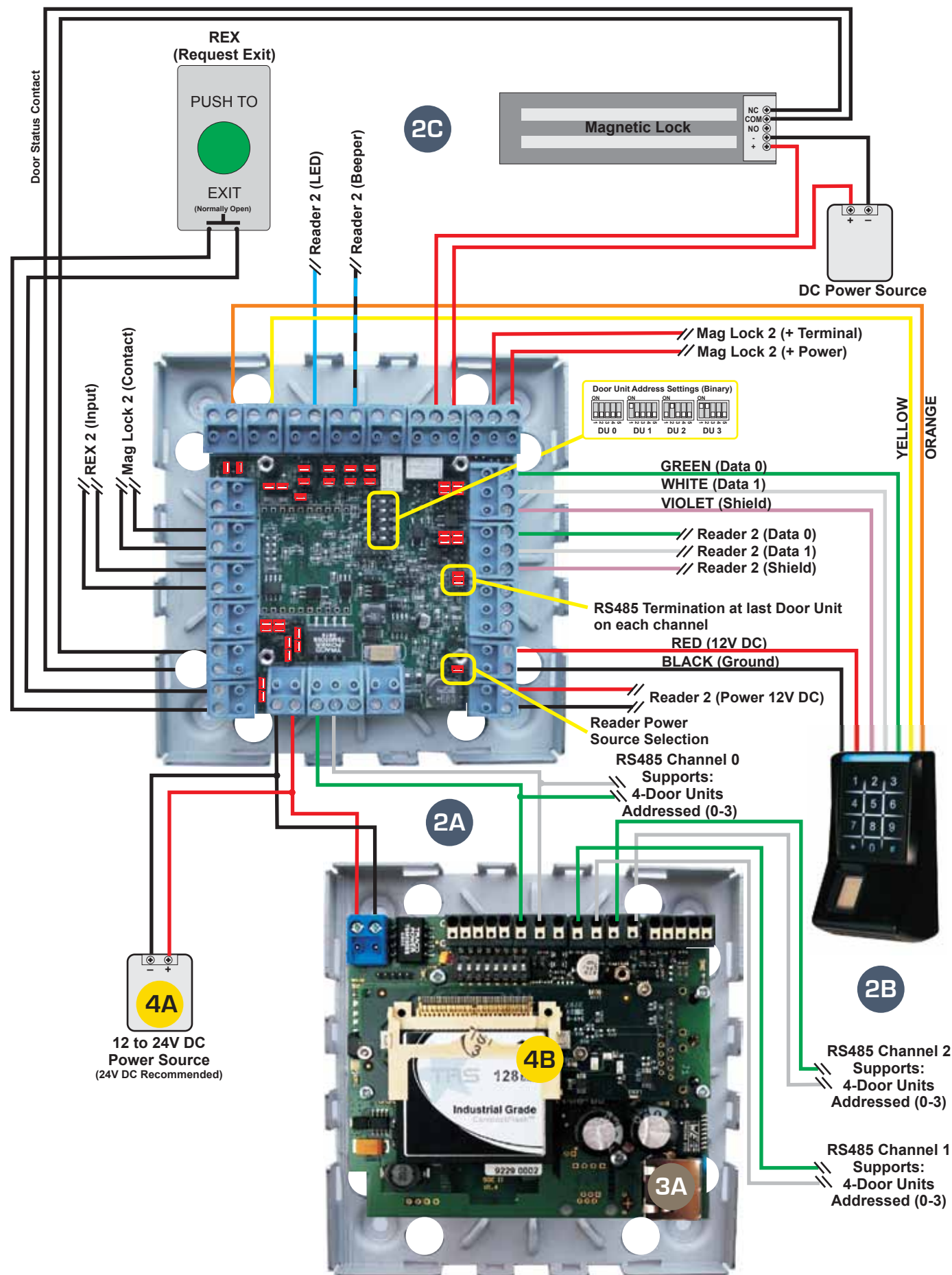

Step 4 POWER ON

- A** Plug in DC power source
- B** Verify the Master Unit 524 LED indicators
 - L1 (On = Future Use)
 - L2&3 (Flashing = Application Running)
 - L4 (On = 3.3 V DC Power On)
 - L5 (On = 5 V DC Power On)
 - L6 (On = USB Power)
 - L7 (On = CPU Power)

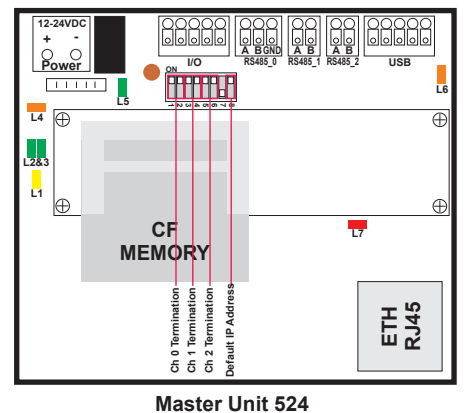

Step 5 LOG IN AND CONFIGURE

- A** Connecting to the Master Unit 524
Open the Web browser of the connected PC
Enter the default IP address of 192.168.50.140 at the address line
The "User Login and Status" screen is displayed



- B** Log in to the system
Enter the name "user1"
Enter the password "pw"
Click Login
- C** Modify the system for your unique application
Modify the pre-loaded configuration to your needs
Enroll Cards and add Persons as required

(see Software Configuration Manual for details)

Step 1 MOUNT

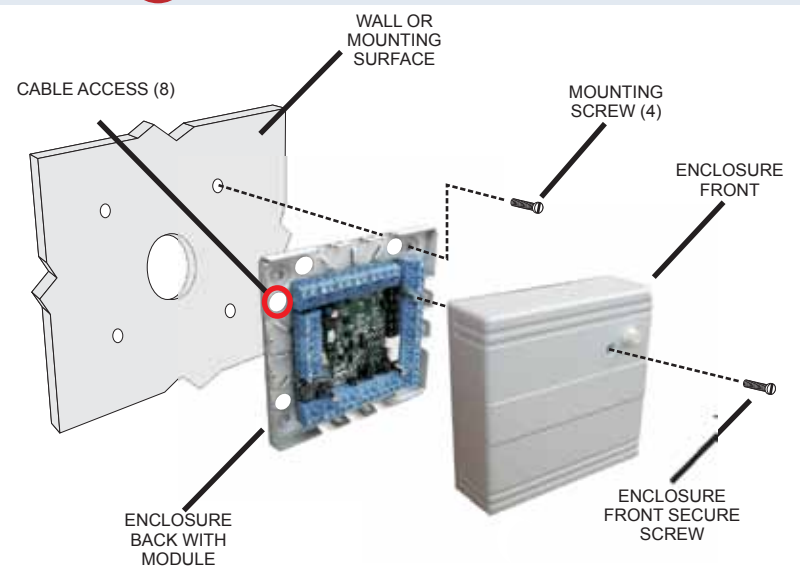

Step 2 WIRE

- A** Connect Master Unit 524 and Door Unit RS485 between Master Unit and Door Unit modules
12 to 24V DC Power Source (24V recommended)
- B** Connect FPK (TLR401B) reader to Door Unit
12V DC (red)
GND (black)
Data 0 (green)
Data 1 (white)
Shield (violet)
Beeper (yellow)
Green LED (orange)
- C** Connect door locking hardware
Locking device (electric strike shown)
Door contact (monitors door status)
Request for exit / PIR (exit button shown)
Locking hardware power (DC Power Source)

Step 3 NETWORK

- A** Ethernet connection
Using CAT5 patch cable connect the Master Unit 524 to an Ethernet router or directly to a PC using a CAT5 crossed cable
- B** Setting the IP address
Set the IP address of the connected PC to allow connection to the Master Unit 524 default IP address 192.168.50.140

(see Software Configuration Manual for details)

For illustration only; local municipality code may require alternate configuration

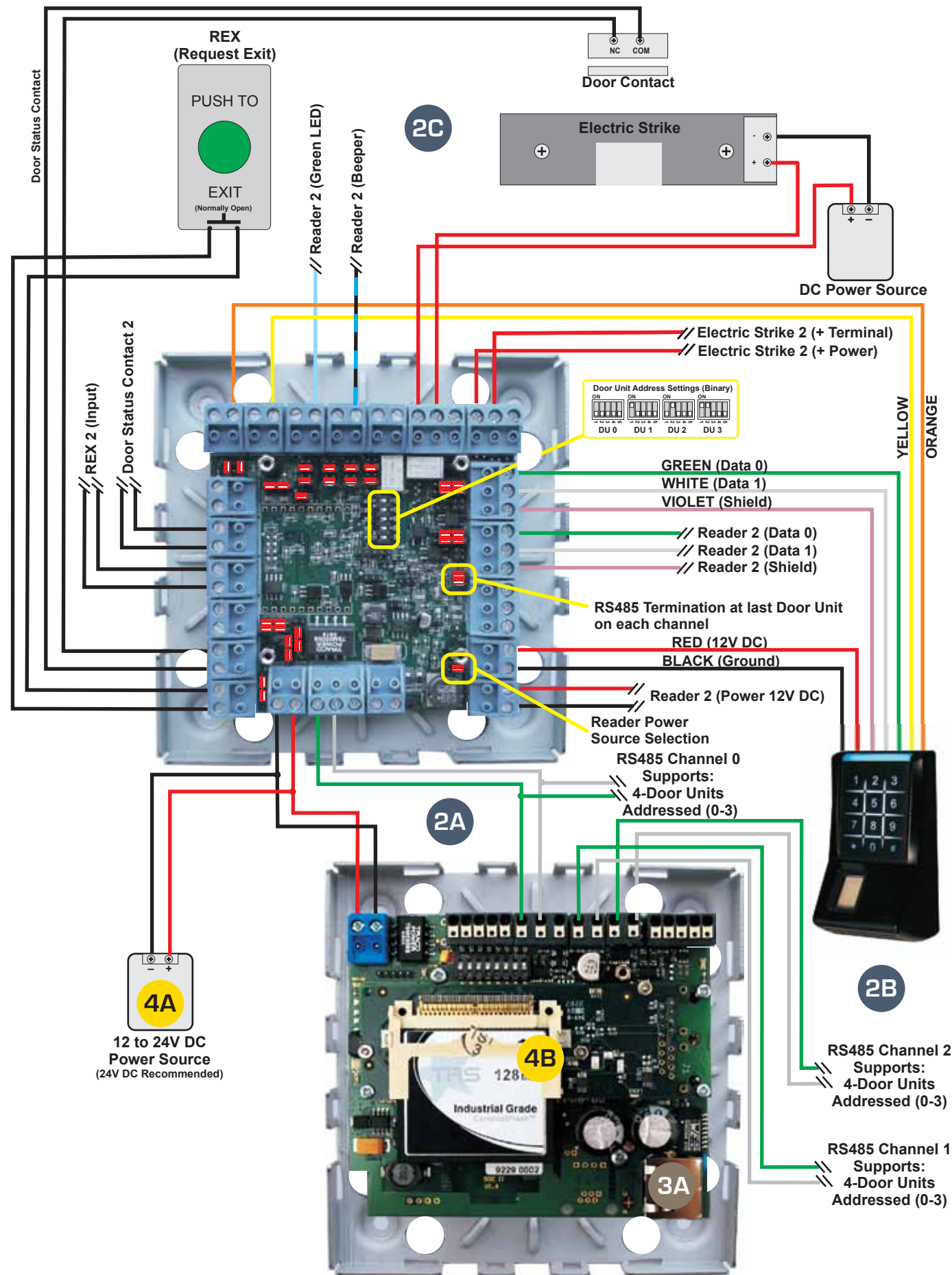

Step 4 POWER ON

- A** Plug in DC power source
- B** Verify the Master Unit 524 LED indicators
 - L1 (On = Future Use)
 - L2&3 (Flashing = Application Running)
 - L4 (On = 3.3 V DC Power On)
 - L5 (On = 5 V DC Power On)
 - L6 (On = USB Power)
 - L7 (On = CPU Power)

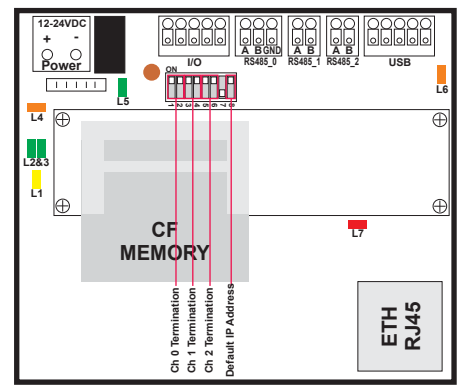

Step 5 LOG IN AND CONFIGURE

- A** Connecting to the Master Unit 524
Open the Web browser of the connected PC
Enter the default IP address of 192.168.50.140 at the address line
The "User Login and Status" screen is displayed



- B** Log in to the system
Enter the name "user1"
Enter the password "pw"
Click Logon
- C** Modify the system for your unique application
Modify the pre-loaded configuration to your needs
Enroll Cards and add Persons as required

(see Software Configuration Manual for details)

Step 1 MOUNT

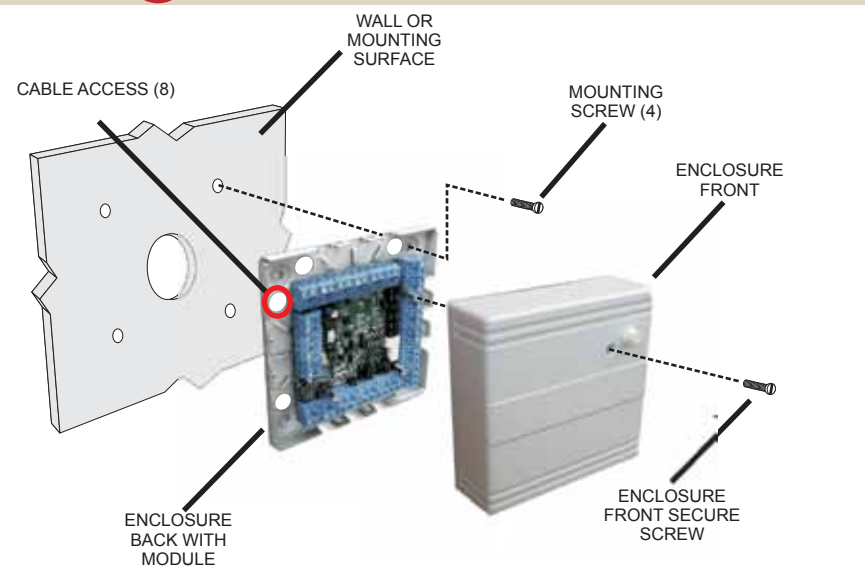

Step 2 WIRE

- A** Connect the Master Unit 524 and Door Unit RS485 between Master Unit and Door Unit modules
- 12 to 24V DC Power Source (24V recommended)
- B** Connect Wiegand reader to Door Unit
 - 12V DC (red)
 - GND (black)
 - Data 0 (green)
 - Data 1 (white)
 - Shield (must be connected)
 - Beeper (yellow)
 - Green LED (orange)
- C** Connect door locking hardware
 - Locking device (magnetic lock shown)
 - Door contact (Integrated in magnetic lock)
 - Request for exit / PIR (exit button shown)
 - Locking hardware power (DC Power Source)

Step 3 NETWORK

- A** Ethernet connection
 - Using CAT5 patch cable connect the Master Unit 524 to an Ethernet router or directly to a PC using a CAT5 crossed cable
- B** Setting the IP address
 - Set the IP address of the connected PC to allow connection to the Master Unit 524 default IP address 192.168.50.140

(see Software Configuration Manual for details)

For illustration only; local municipality code may require alternate configuration

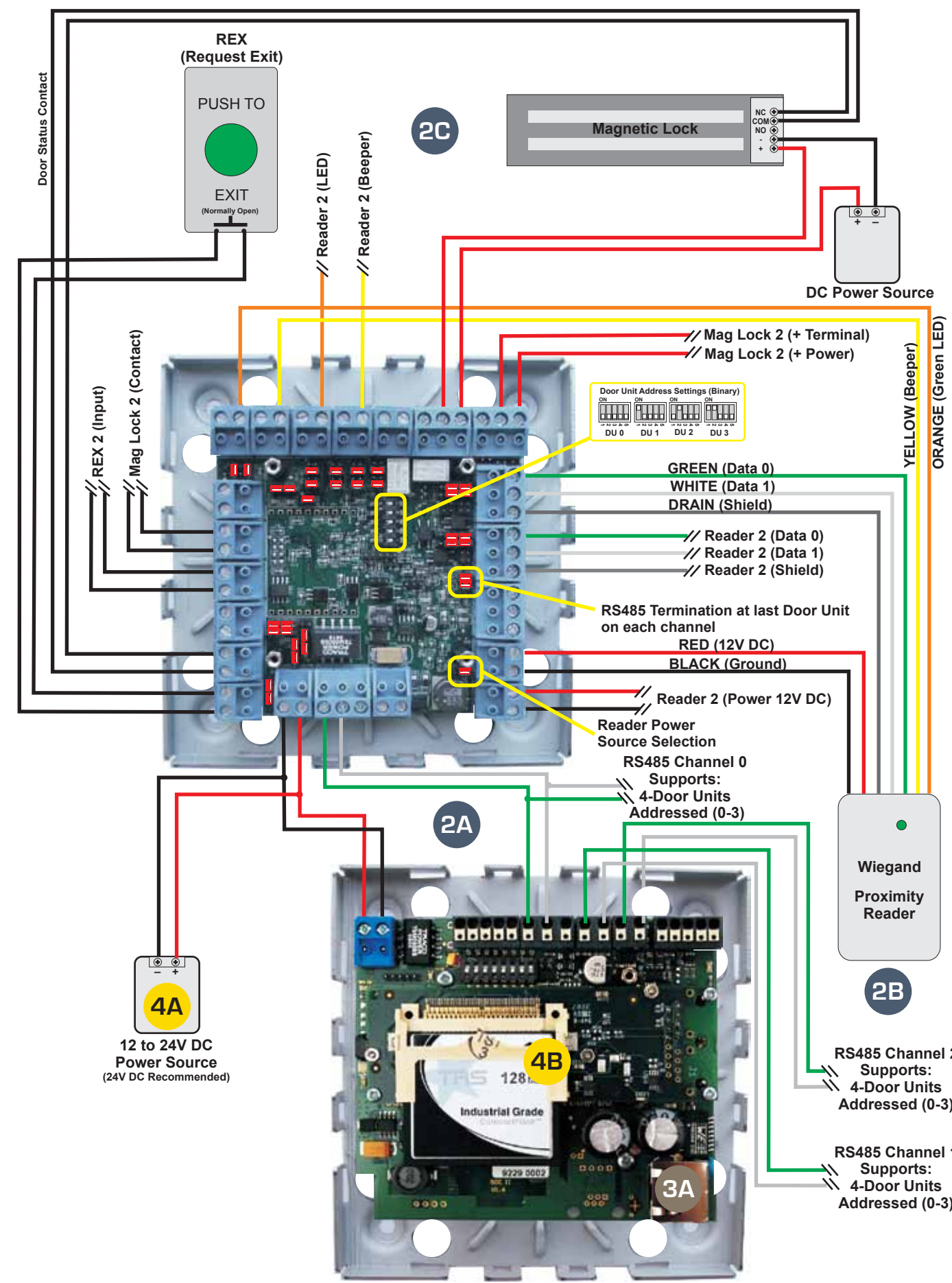

Step 4 POWER ON

- A** Plug in DC power source
- B** Verify the Master Unit 524 LED indicators
 - L1 (On = Future Use)
 - L2&3 (Flashing = Application Running)
 - L4 (On = 3.3 V DC Power On)
 - L5 (On = 5 V DC Power On)
 - L6 (On = USB Power)
 - L7 (On = CPU Power)

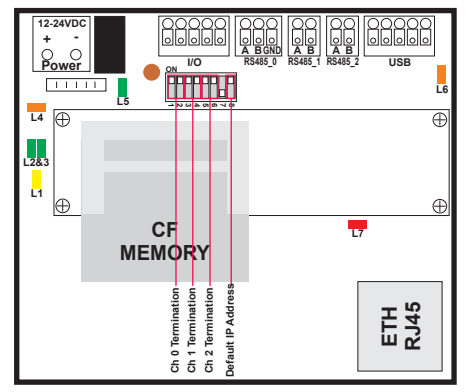

Step 5 LOG IN AND CONFIGURE

- A** Connecting to the Master Unit 524
 - Open the Web browser of the connected PC
 - Enter the default IP address of 192.168.50.140 at the address line
 - The "User Login and Status" screen is displayed



- B** Log in to the system
 - Enter the name "user1"
 - Enter the password "pw"
 - Click Login
- C** Modify the system for your unique application
 - Modify the pre-loaded configuration to your needs
 - Enroll Cards and add Persons as required

(see Software Configuration Manual for details)

Step 1 MOUNT

Step 2 WIRE

A Connect the Master Unit 524 and Door Unit RS485 between Master Unit and Door Unit modules
12 to 24V DC Power Source (24V recommended)

B Connect Wiegand reader to Door Unit
12V DC (red)
GND (black)
Data 0 (green)
Data 1 (white)
Shield (must be connected)
Beeper (yellow)
Green LED (orange)

C Connect door locking hardware
Locking device (electric strike shown)
Door contact (monitors door status)
Request for exit / PIR (exit button shown)
Locking hardware power (DC Power Source)

Step 3 NETWORK

A Ethernet connection
Using CAT5 patch cable connect the Master Unit 524 to an Ethernet router or directly to a PC using a CAT5 crossed cable

B Setting the IP address
Set the IP address of the connected PC to allow connection to the Master Unit 524 default IP address 192.168.50.140
(see Software Configuration Manual for details)

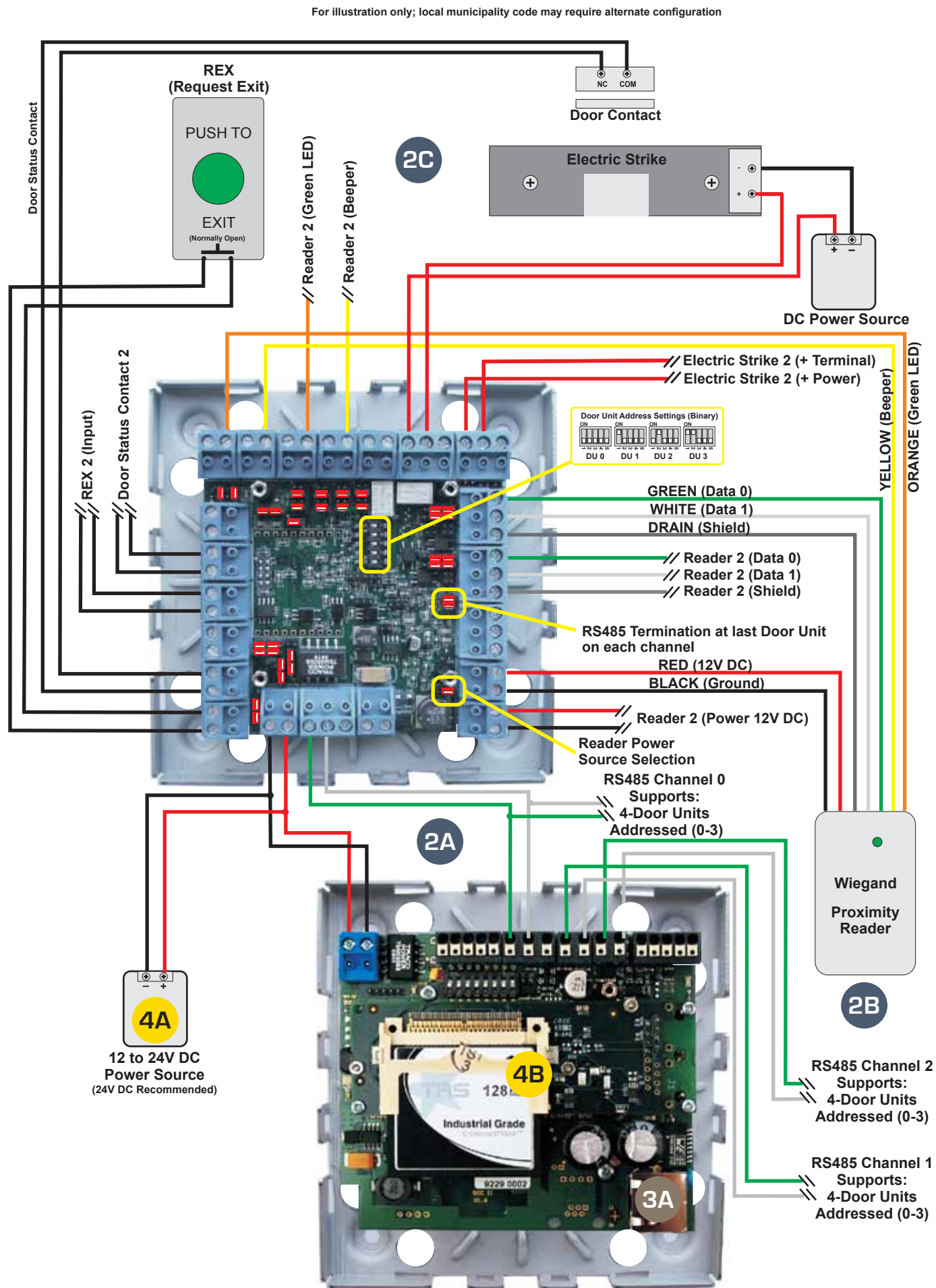

Step 4 POWER ON

A Plug in DC power source

B Verify the Master Unit 524 LED indicators

- L1 (On = Future Use)
- L2&3 (Flashing = Application Running)
- L4 (On = 3.3 V DC Power On)
- L5 (On = 5 V DC Power On)
- L6 (On = USB Power)
- L7 (On = CPU Power)

Master Unit 524

Step 5 LOG IN AND CONFIGURE

A Connecting to the Master Unit 524
Open the Web browser of the connected PC
Enter the default IP address of 192.168.50.140 at the address line
The "User Login and Status" screen is displayed

B Log in to the system
Enter the name "user1"
Enter the password "pw"
Click Logon

C Modify the system for your unique application
Modify the pre-loaded configuration to your needs
Enroll Cards and add Persons as required
(see Software Configuration Manual for details)